

# *Hydria III*



## **WARNING**

1. Do not let the lamp or adapter touches water!
2. Children should be supervised to ensure they do not play with it.

---

## INTRODUCTION

1: Grow lamp

2: The stand

3: Add water: cap

4: Grow Basket

5: Grow Deck

6: Water tank

7: Power Cord & Controller

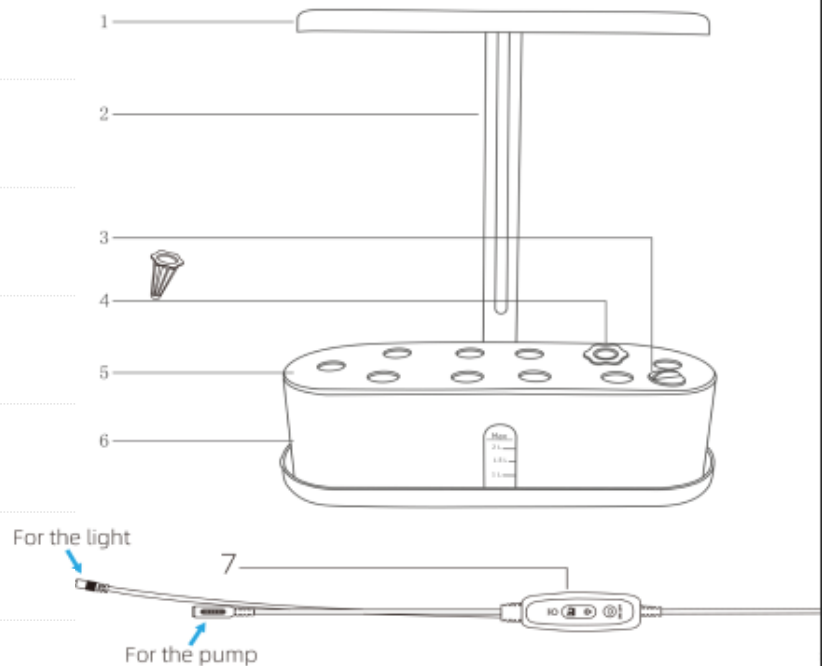

---

## ABOUT THE SENSOR PUMP:

When the water level is below the sensor, the pump would stop working and blinks green light to inform you to add water.

*( Tips: When the pump runs without enough water, would get broken fast. )*

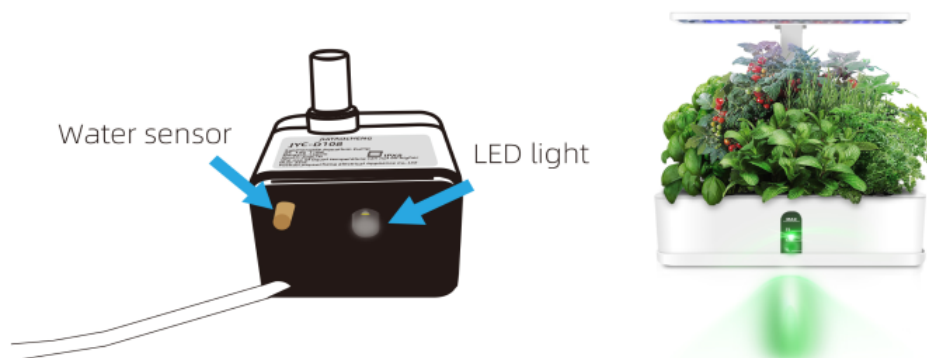

# SPECIFICATIONS

<b>Dimensions</b>	380*130*115mm
<b>Adapter Spec</b>	Input: 110V-240V / 50-60Hz
	Output: 12V / 2A
<b>Power</b>	24W
<b>Water Tank Capacity</b>	2.5L
<b>Capability</b>	10 pods
<b>Product Type</b>	Indoor Garden
<b>LED Light</b>	Full spectrum

## WORKING TIME

- Turn on the LED light by pressing the ON/OFF button on controller after power on.
- The garden kit has a fixed working time and cannot be changed.
- Works 16 hours everyday/cycle. (Works 16 hours and rest 8 hours)
- **The light:** First 2h 50% brightness (sunrise), then 12h 100%, and last 2h 50% (sunset).
- **The pump:** Works 10 minutes and rest 10 minutes, cycle.

## Take All parts out from the water tank

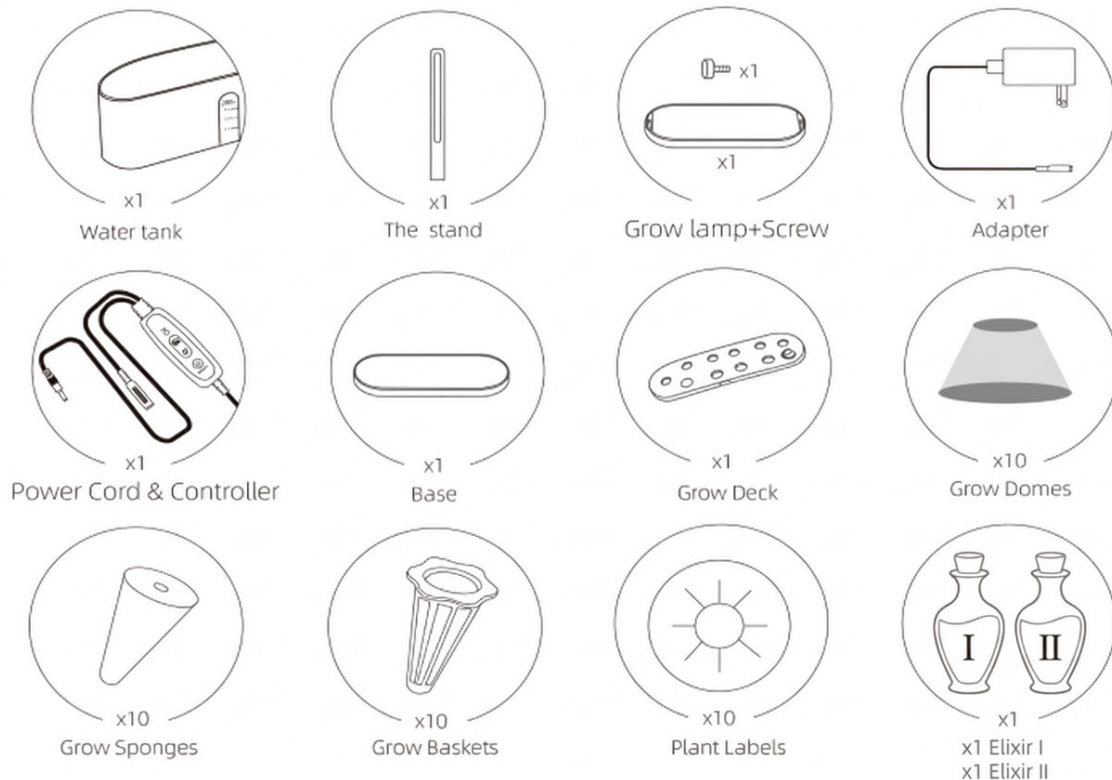

# INSTALLATION

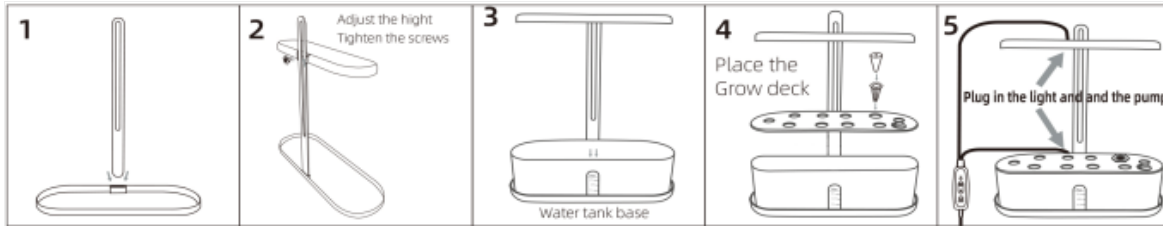

1. Insert the stand into the base.
2. Fix the grow lamp into the stand with the screw and adjust the height desired.
3. Put the water tank on the base.
4. Place the grow deck and insert the Grow Basket with sponge.
5. Plug in the led light and the pump.

# PLANTING SEEDS

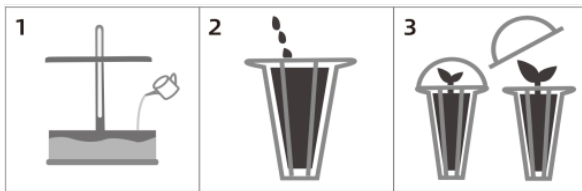

1. Add 2.5L water without fertilizer. Wait 14 days before adding the fertilizer (elixir).
2. Each hydroponic growing sponge has a hole for the seeds. The seeds provided in the kit have a 95% germination rate. Place 1 to 2 seeds per hole.

# ELIXIR PREPARATION

After 14 days, the first leaf of your plant should appear. It is now time to prepare the fertilizer.

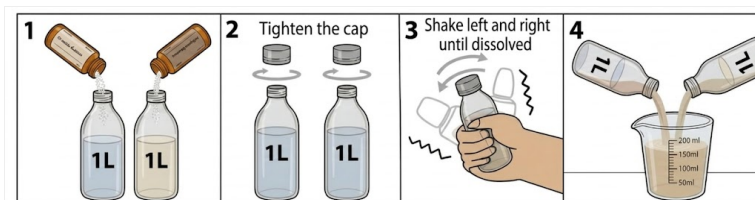

1. Take 2 separate 1L containers. Add the entire contents of each elixir powder into 1L of water per container.

**IMPORTANT:** Do not mix the powders together. Dissolve each elixir separately in water first, as they may react and form crystals. Once fully dissolved, they can be safely combined.

2. Once mixed, these solutions last up to 10 months if stored in a cool, dark place. Using a measuring cup, add 100 ml from each bottle to the tank every 28 days.

*Note: Top up the tank with pure water if the volume falls below 1.5 L.*

# FROM SOIL TO WATER

---

In nature, plants do not consume the soil itself. Instead, they absorb the minerals that water slowly releases from rocks and soil.

*Rainwater travels through mountains, dissolving tiny traces of calcium, potassium, magnesium, and other essential elements. These minerals then eventually reach the soil water, where roots can absorb them. Hydroponics simply reproduces this natural process — but in a more direct way.*

## AN ANCIENT SCIENCE

---

What we call chemistry today is simply the art of isolating these essential elements with precision. The elixirs in this kit are composed of these minerals, in a pure and immediately absorbable form, and are presented in this booklet as two preparations.

**Elixir I** — The Radiance of Calcite

**Elixir II** — The Essence of Chlorophyll



# *The Calcite Radiance*

(Calcium Nitrate) — Elixir I

In the absence of soil to support its roots, the plant draws from this concentrate the strength to build its own walls. It is a product of the earth, refined by science to offer the plant its strongest framework.

## **WHERE DOES IT COME FROM?**

Calcium Nitrate primarily comes from limestone (calcite), the same rock that forms chalk cliffs and marble mountains.

## **THE EXTRACTION**

Through a purification process, calcium is extracted from the rock to be married with nitrogen from the air, making it immediately available to your plants.



### *Its mission:*

In nature, calcium is released very slowly by the erosion of mountains. Here, Calcium Nitrate is already "released" so that your plant can use it instantly to harden its stems and strengthen its structure.

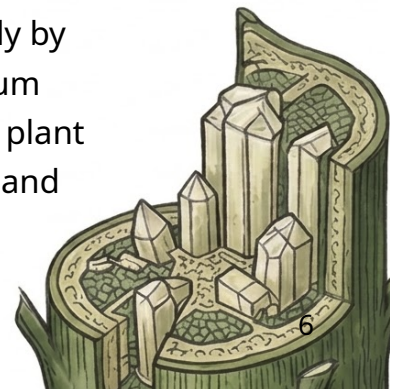

# *The Essence of Chlorophyll*

(Masterblend & Epsom Salt) — Elixir II

This concentrate allows water to become nurturing. It brings iron, sulfur, and magnesium — the elements that allow the leaf to capture light and transform it into plant life.

## WHERE DOES IT COME FROM?

- **Magnesium Sulfate (Epsom Salt):** It comes from underground mineral sources or evaporated seawater deposits.
- **Masterblend:** A blend of phosphorus (fossil phosphate rocks), potassium (fossilized sea salt), and natural trace elements (iron, boron, zinc) found in the Earth's crust.

## ITS MISSION

In nature, photosynthesis depends on these minerals to transform light into energy and feed the plant. The Essence of Chlorophyll makes this process immediate and efficient, supporting every leaf, every stem, every flower.

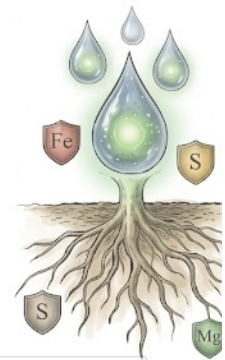



*Thank you for buying at ManorLeaf*

 Made in Canada